

ASTON CHASE



PRINCE ALBERT ROAD
London, NW8

ASKING PRICE
£2,500 per week

ASTON CHASE

PRINCE ALBERT ROAD

An exciting opportunity to rent a sixth floor, three double bedroom apartment (154 sq m/1,665 sq ft) in this prestigious portered block offering stunning views over Regent's Park and the City of London. This well arranged property offers a good balance between living and bedroom accommodation and is focused around a generously sized South-East facing balcony that is accessed from the three principal rooms in the apartment. Further benefits include 24 hour porter, air conditioning, underground parking and basement store cupboard.

Imperial Court is conveniently located within a short distance of the various amenities and eateries of St John's Wood High Street, St John's Wood Underground Station (Jubilee Line) and the green open spaces of Regent's Park.

ACCOMMODATION

Principal Bedroom with En-Suite Bathroom, Two Further Bedrooms, Family Bathroom, Reception Room, Dining Room, Kitchen, Guest cloakroom

AMENITIES

Air Conditioning
24 Hour Porter
Underground Parking For One Car



ASTON CHASE



ASTON CHASE



Imperial Court,
Prince Albert Road,
London NW8

Approximate Gross Internal Area:
153.3 sq.m. / 1650 sq.ft.

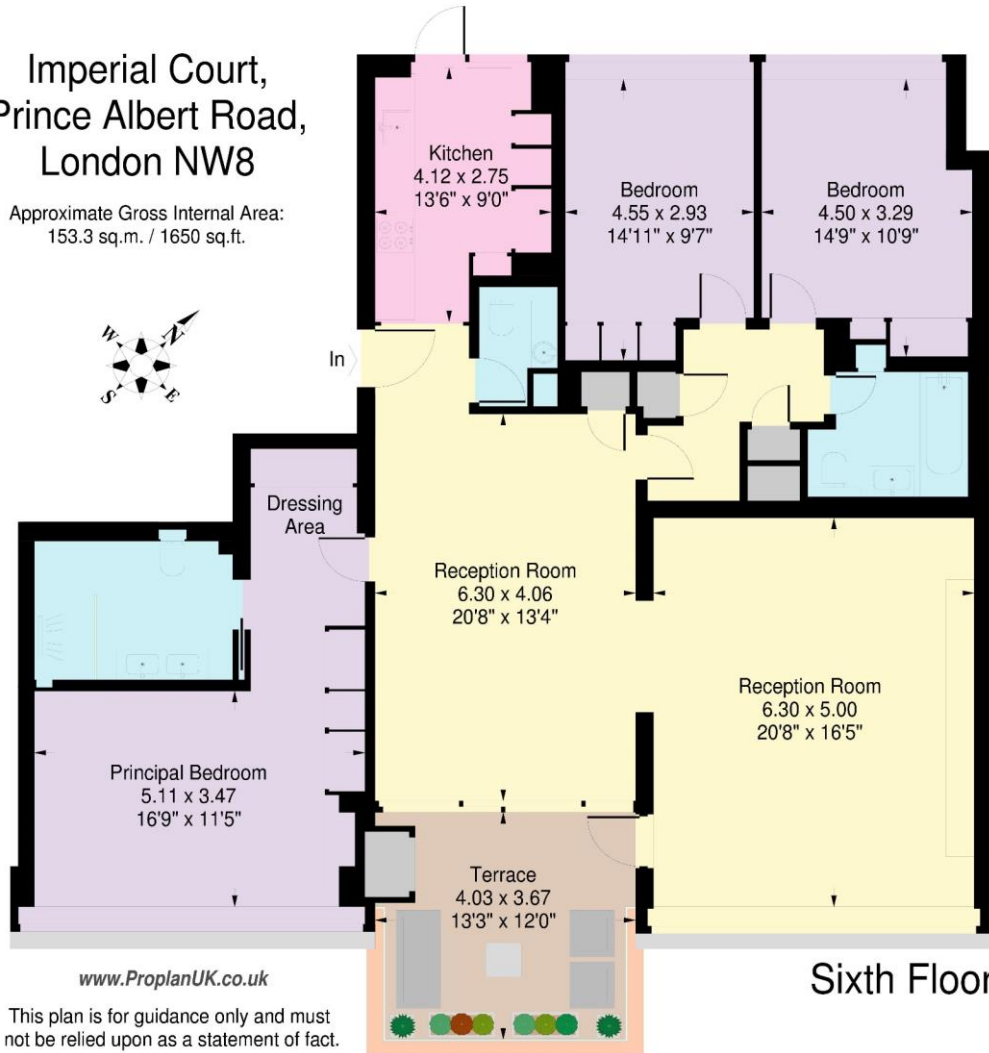

www.ProplanUK.co.uk

This plan is for guidance only and must not be relied upon as a statement of fact.

Sixth Floor

67-71 Park Road
Regent's Park
London NW1 6XU

020 7724 4724

astonchase.com



IMPORTANT NOTICE

These particulars are a guide given in good faith and are believed to be correct at the time of printing. Aston Chase give no representation as to their accuracy and potential purchasers or tenants must satisfy themselves by inspection or otherwise as to their correctness. No employee of Aston Chase has authority to make or give any representation or warranty in relation to this property.