



## HILLSIDE COURT

Finchley Road  
London  
NW3

Asking Price  
£635,000

Joint Sole Agent

A well-proportioned four-bedroom first floor apartment (94.20 sq m / 1,014 sq ft) situated within Hillside Court on Finchley Road, NW3. The apartment offers bright and versatile accommodation throughout, benefiting from excellent natural light, well-balanced living space and a private balcony.

The property features a spacious reception room ideal for both entertaining and family living, a separate fitted kitchen, a generous principal bedroom with built-in wardrobes and balcony access, three further bedrooms, a family bathroom, separate shower room, and excellent overall storage. The layout offers flexibility for both families and those requiring additional guest accommodation or home office space.

# ASTON CHASE

67-71 Park Road  
Regent's Park  
London, NW1 6XU  
020 7724 4724  
enquiries@astonchase.com

astonchase.com

## HILLSIDE COURT

Finchley Road  
London  
NW3

Asking Price  
£635,000  
Subject To Contract

Joint Sole Agent

Leasehold 979 Years Remaining

Service Charge: £6,748.00

Hillside Court is conveniently positioned on Finchley Road, within easy reach of the cafés, restaurants and shops of Hampstead, St John's Wood and Swiss Cottage. The building further benefits from portorage, a passenger lift, and well-maintained communal gardens. Excellent transport links are nearby including Finchley Road Underground Station (Jubilee & Metropolitan Lines) and South Hampstead Overground Station, providing quick access into the West End and City.

\*PLEASE NOTE; Computer-generated images and are intended for illustrative purposes only and should be treated as general guidance only.



# ASTON CHASE

67-71 Park Road  
Regent's Park  
London, NW1 6XU  
020 7724 4724  
enquiries@astonchase.com

astonchase.com

## ACCOMMODATION

- Principal bedroom with en-suite & access to private balcony
- Additional three spacious bedrooms
- Separate kitchen
- Living/dining space
- Family bathroom

## AMENITIES

- Communal gardens
- Porterage
- Passenger lift

COUNCIL TAX: F

EPC RATING: C



# ASTON CHASE

67-71 Park Road  
Regent's Park  
London, NW1 6XU  
020 7724 4724  
enquiries@astonchase.com

astonchase.com



# ASTON CHASE

67-71 Park Road  
Regent's Park  
London, NW1 6XU  
020 7724 4724  
[enquiries@astonchase.com](mailto:enquiries@astonchase.com)

[astonchase.com](http://astonchase.com)



# ASTON CHASE

## Hillside Court, Finchley Road, NW3

Approximate gross internal area  
1014 sq ft / 94.20 sq m

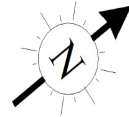

Key :  
CH - Ceiling Height

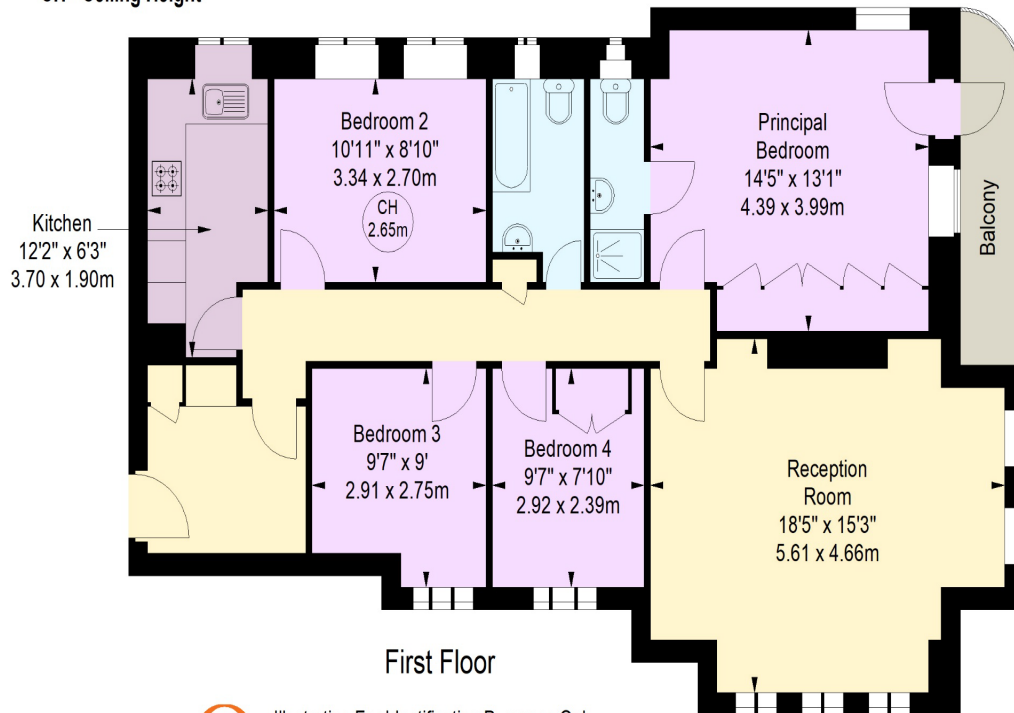

Illustration For Identification Purposes Only.

All measurements and areas are approximate, not to scale.

© Orange Tree Photography

Score	Energy rating	Current	Potential
92+	A		
81-91	B		
69-80	C	69 C	76 C
55-68	D		
39-54	E		
21-38	F		
1-20	G		

67-71 Park Road  
Regent's Park  
London, NW1 6XU  
020 7724 4724  
enquiries@astonchase.com

astonchase.com



### Important Notice

These particulars have been prepared in all good faith to give a fair overall view of the property and must not be relied upon as statements or representations of fact. Purchasers must satisfy themselves by inspection or otherwise regarding the items mentioned below and as to the content of these particulars. If any points are particularly relevant to your interest in the property ask for further information.